

# HYDRO TWISTER ANT4C

EFFECTIVE 12-1-12  
SN 201202789

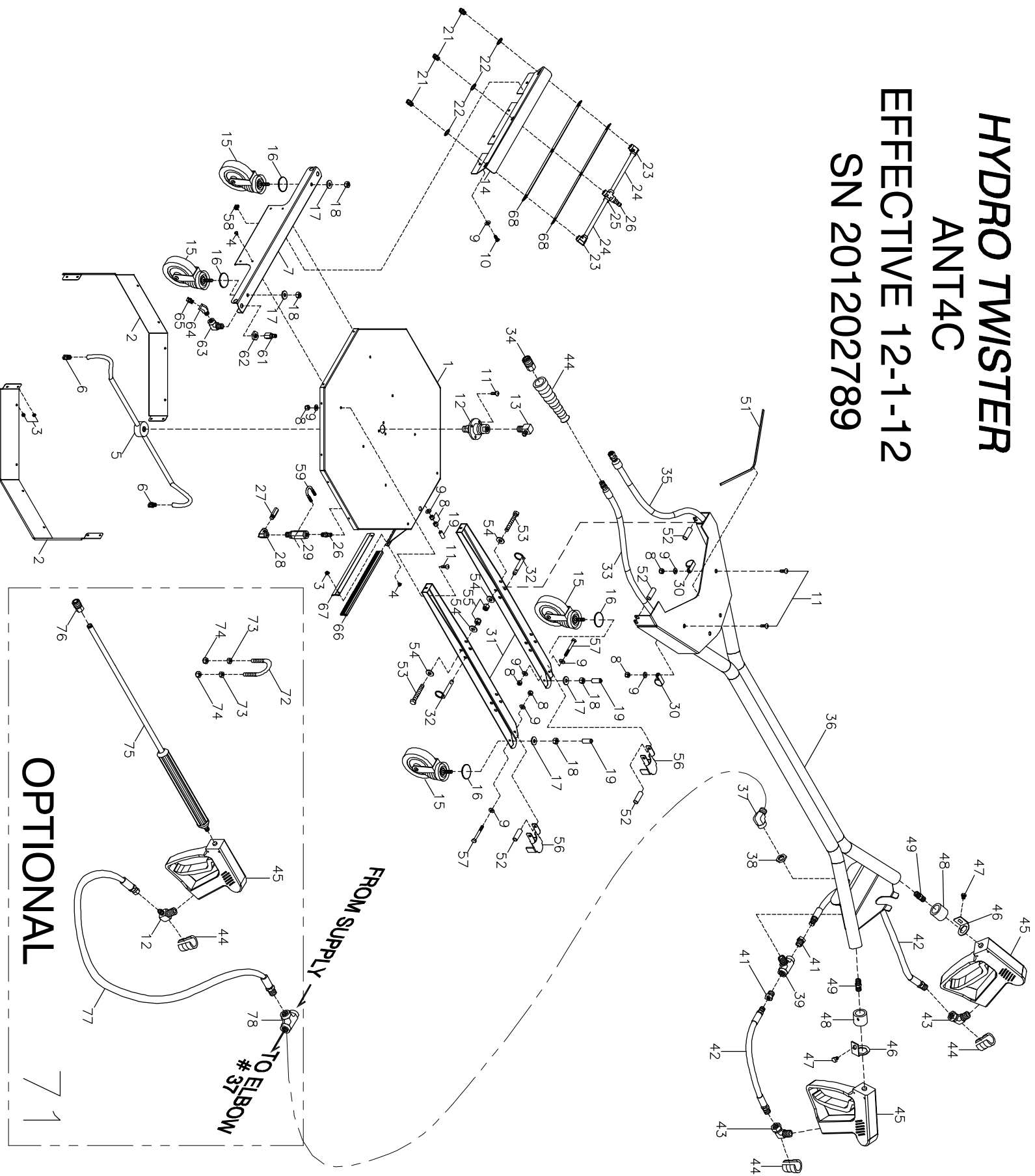

OPTIONAL

7 1

# ANT4C PARTS LIST

S/N201202789

12/01/2012

1	HLS42-1	DECK - ANT4C	42	DH105	HOSE 1/4" x 19" 5000PSI/GAUGE
2	HLS45	SKIRT - ANT4C	43	DE866	SWIVEL 3/8"F x 3/8"M 90 BRAZED!!
3	FNF10	10/24 SERRATED NUT STAINLESS	44	ECH75	HEAVY DUTY BEND RESTICTOR - B
4	FB316	10/24 x 3/8 TRUSS SCREW STAINLESS	45	VG200	TRIGGER GUN, INSULATED 4000PSI
5	VAM25	TWISTER ROTAR ARM 26.5"	46	HLS02	GUN RETAINING BRACKET STAINLESS
6	NM270	NOZZLE 027 x 15 x 1/8 MEG	47	FB507	BOLT 5/16" x 3/8" STNLS
7	HLS42-2	FRONT CASTER BRACKET-ANT4C	48	HLS10	GUN/TUBING ADAPTER-STEEL
8	FNLS4	NUT LOCK; 1/4-20 316 STAINLESS	49	DB504	NIPPLE 1/4" STEEL
9	FWS04	WASHER SAE 1/4"SS 9/32 x 58*	50		
10	FB412	BOLT 1/4" x 3/4" HEX STNLS	51	HLO23	TRIMLOCK 75B-3 x 1/8***
11	FB410	BOLT 1/4" x 3/4" PHIL HD SLT STNL	52	HSC44	HANDLE PIVOT BOLT SPACER
12	VAM04	TWISTER SWIVEL CARBIDE 4000	53	FB641	BOLT 3/8" x 2 1/2" PLD ALL-THREAD
13	D5546	STREET ELL 3/8"MPT x 1/4"JIC	54	FWC05	WASHER CUT 5/16 PLD*
14	HLS42-3	SWEEPER BRACKET-ANT4C	55	FNL06	NUT-LOCK 3/8"-16 PLD
15	HT300	CASTER 3 DIA x 15/16 TREAD WIDTH	56	HLS26	RIGID CASTER BRACKET
16	DQ605	O-RING 3/32 x 1 5/8 x 13/16	57	FB436	BOLT 1/4" x 2 1/4" STAINLESS STEEL
17	FWC05	WASHER CUT 5/16" PLD*	58	FNS04	1/4 - 20 SQUARE SPEED NUT
18	FNR06	NUT 3/8-16 PLD	59	FB990	U-BOLT 1/4-20 x 1" x 1 3/4"
19	HLC16	CASTER CAP; TWISTER 1 .343 BL	60		
20			61	DQ04F	COUPLER 1/4" PLUG FEM
21	NN204	NOZZLE 02 x 40	62	D7064	HEX NUT 1/4" BRASS
22	HLS19-2	WASHER .56ID X .80OD 12 GA STAINLESS	63	DC043	STREET ELL 1/4 STEEL
23	DC044	DECK - ANT4C	64	DM044	STREET ELL 1/4 - 45 DEG STEEL
24	VW008	WAND 1/4" x 8" STAINLESS STEEL	65	NN502	NOZZLE 05 x 15 DEG
25	DA244	CROSS 1/4" STEEL	66	HLH96	BRUSH 1.00 x 15.25
26	DQ04M	COUPLER 1/4" PLUG MALE	67	HLS42-4	BRUSH RETAINER
27	NTM55	NOZZLE MULTIPOINT TWISTER # 5.5	68	HLS42-5	NOZZLE SHIM 16.GA
28	DC047	ELL 1/4"FP x 1/8"FP STEL	69		
29	VF054	HIGH PRESSURE STRAINER 400DEG	70		
30	FD050	CLAMP 1/2" RUBBER COATED		GLL66	LABEL HYDRO TWISTER 10 x 10.75 (NOT SHOWN)
31	HLS43	REAR CASTER BRACKET-ANT4C	<b>OPTIONAL</b>		
32	FP378	QUICK RELEASE PIN 3/8" 1.8 IN	71	ANTGN	GUN/WAND KIT FOR TWISTERS
33	DTW03	HOSE ASSEM 1/4" x 63" 5000 PSI	72	FB995	U-BOLT 1/4-20 FOR 1 in GAS PIPE
34	DQ04S	COUPLER 1/4" SOCK FEM INSULATED	73	FNR04	NUT 1/4-20 PLAIN STNLS
35	DTW06	HOSE ASSEM 1/4" x 54" 5000 PSI	74	FNLS4	NUTLOCK; 1/4-20 316STAINLESS
36	HLS3C	HANDLE ASSEMBLY ANT3C	75	VW036	WAND 1/4" x 36" MOLDED GRIP 580
37	DC568	STREET ELL 3/8" STEEL	76	DQ04S	COUPLER 1/4" SOCK FEM
38	D7061	HEX NUT 3/8" BRASS-REMOTE UNLOADER	77	DTW02	HOSE ASSEM 1/4" x 42" 5000PSI
39	DEB66	BRANCH TEE 3/8" STEEL	78	DE066	TEE 3/8" STEEL
40					
41	DA064	BUSHING 3/8" x 1/4" STEEL			